Main parts needed to mount the extrusion

Aluminum profile (A)



End cap (B)



End cap with hole (C)



Cover (D)



LED strip(E)



Plastic clip(F)



Metal clip(G)



Adjustable bracket(H)

Tools needed for mounting:

Screwdriver and Glue

Sales@infigreen.com

The first option: 1. Mount the LED strip(E),insert the cover(D),insert the end cap(B) and (C).

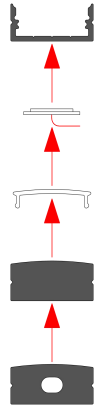

2. Mount the metal clip(G) on the ceiling.

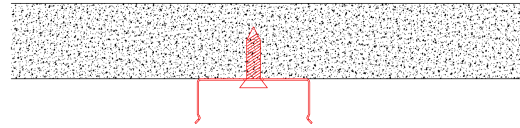

3. Mount the profile on the clip,lead out the power cable.

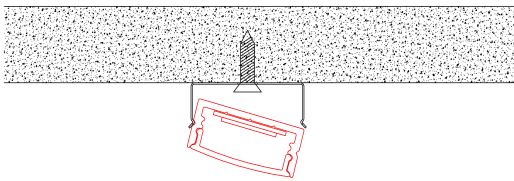

4. Run the cable to the power source,connect power.

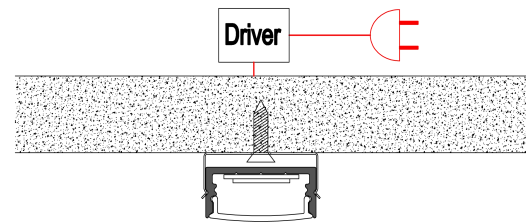

The second option: 1. Spread glue in the groove.

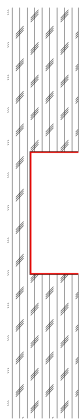

2. Insert the end cap(B) and (C),then attach the profile to the groove.

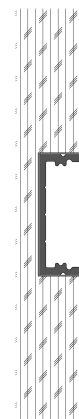

3. Mount the LED strip(E),insert the cover(D),lead out the power cable.

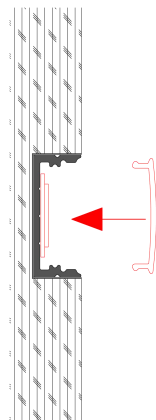

4. Run the cable to the power source,connect power.

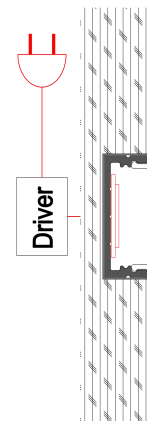

The third option: 1. Mount the LED strip(E),insert the cover(D),insert the end cap(B) and (C).

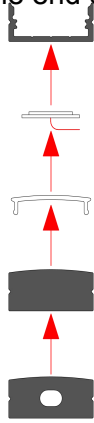

2. Mount the adjustable clip(H) on the wall.

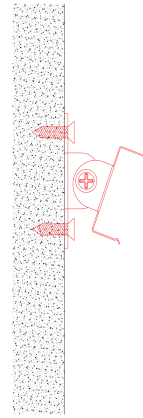

3. Mount the profile on the clip, lead out the power cable.

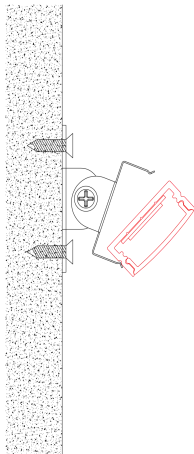

4. Adjust the profile angle.

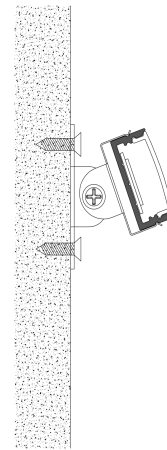

5. Run the cable to the power source, connect power.

