Main parts needed to mount the extrusion

End cap (B)



End cap with hole (C)

Tools needed for mounting:

Screwdriver & Glue

 Contact: Sales@infigreen.com

Specification	
Aluminum Profile:	6063-T5
Diffuser:	PCdiffusedcover/PMMAopalcover/PMMAsemi-clearcover/PMMAclearcove
Length:	2000mm/2500mm/3000mm
Finish:	Silver Anodized, Powder Coated White, Black or Other Color
Installation:	Recessed

Other Mounting Instruction

Option#1 - 1. Spread Glue in the Groove



2. Insert the End Cap (B) and (C), then attach the Profile to the Groove

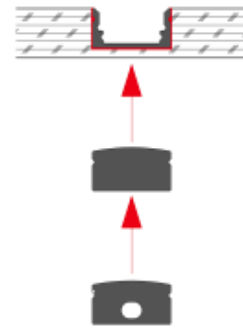

3. Mount the LED strip (E), insert the cover (D), Lead out the power cable

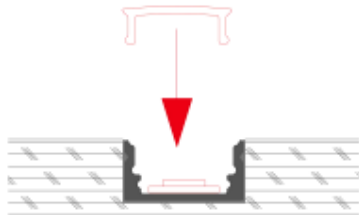

4. Run the cable to the power source, then connect power

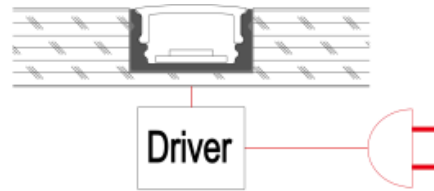

Option#2 - 1. Mount the LED Strip (E), insert the cover (D), insert end cap (B)

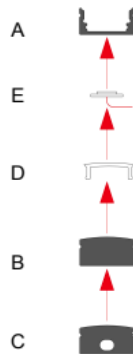

2. Mount the metal clip (F) on the board

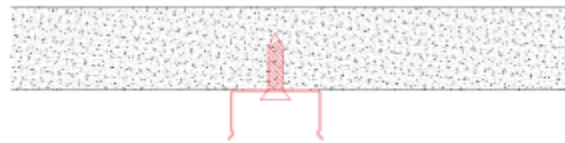

3. Mount the profile on the clip, lead out the power cable

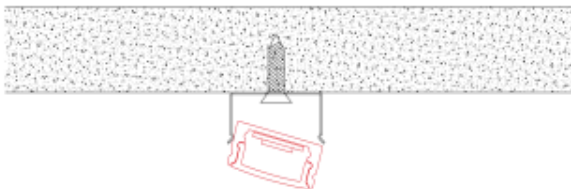

4. Run the cable to the power source, connect power

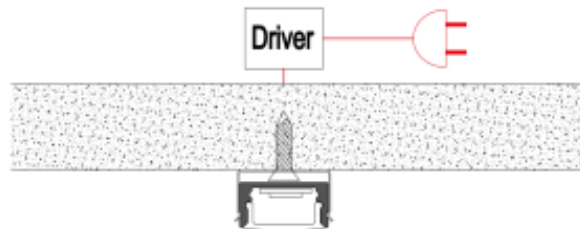

Option#3 - 1. Mount the adjustable clip (G) on the wall

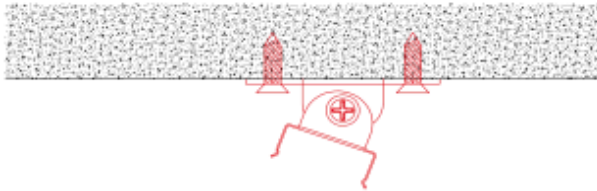

2. Mount the profile on the clip, lead out the power cable

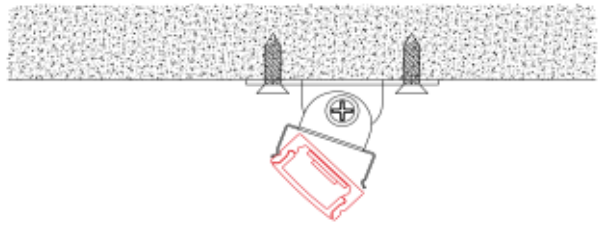

3. Adjust the profile angle

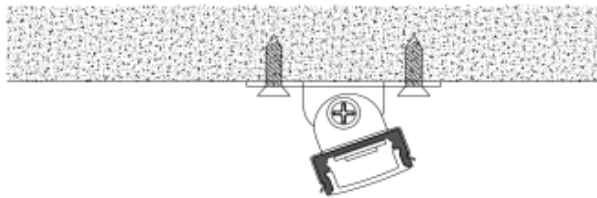

4. Run the cable to the power source, connect power

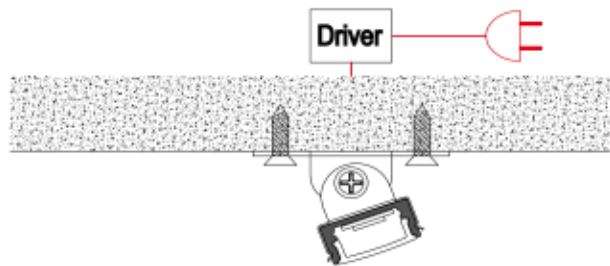

ALP6006 Accessories

EC-ALP6006

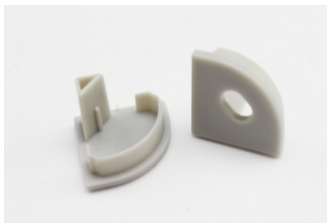

End Cap With Hole

EC-ALP6006



End Cap With Hole

MC-ALP6006



Metal Clip