

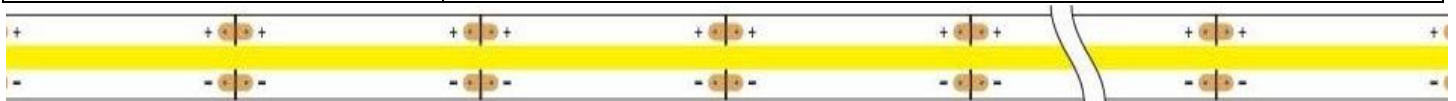

Product Description

Infinity Green (IG) Lighting Corporation LED Strip Kit provides a full set of equipment to help you thrive your construction installation. Infinity Green Lighting serves Flexible LED strip lights to a whole new level that provides a unique architectural design and variety of features. Not all LED products are made equal. Our superior quality flexible COBs come with various colors and are very user friendly in most situations. IP20 has Up to 528 chips on 1 meter PCB, between chips. IP20 can be customized the way you wanted, allowing you to cut pieces to the exact length that you needed for preference. Adjustment switch and power adapter included as a set kit to help with your operation



Specification Information	
Length:	5m (16.4ft)
Rated Power (LED Strip):	24v/30W
Chips:	320 Pcs/m
Cutting Unit:	Every 1.97 in (50mm)
Dimmer:	Mini Controller
Adapter:	AC100-240V, 50-60Hz
Rated Power (Adapter):	36V1.5A/36W
Length:	5m (16.4ft)

Features
- Decent Display Light Source
- Under-Shelf & Under Cabinet
- User and Installation Friendly
- Long Distance Strip Run
- Low Profile/Great Flexibilities
- 3M Installation Stick Tapes
- Various Dimmable Option
- Channel Options
- Adjustable Cutting
- UL Listed

Ordering Steps

Product Purchasing Guideline

	Model Number	-	Color Temperature	-	Meter
Ex:	LS	-	2430	-	5m
	LS		2430	→	3000K
			2450	→	5000K
			24BL	→	BLUE
			24GR	→	GREEN
			24RED	→	RED
			24YW	→	YELLOW
					5M
					5M
					5M
					5M
					5M
					5M



Installation Steps

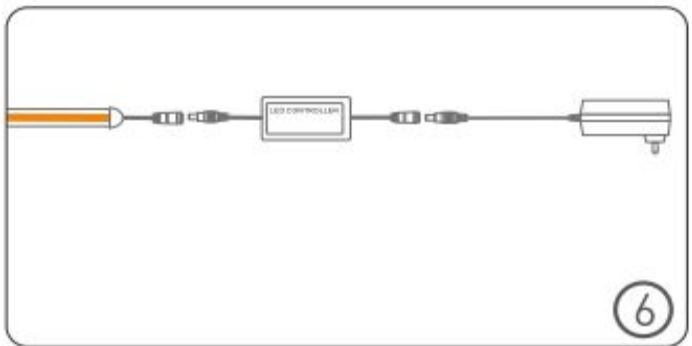
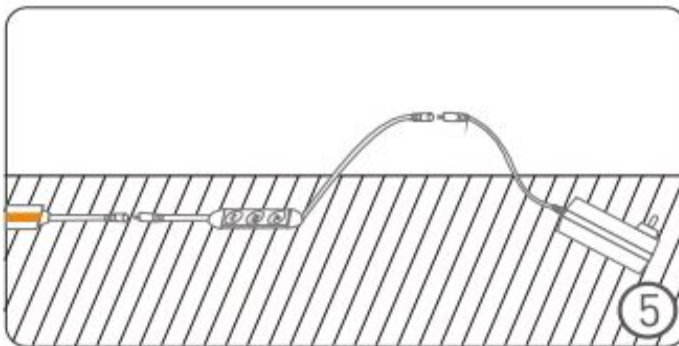
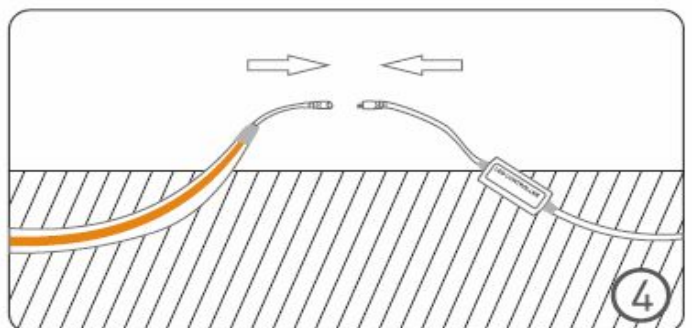
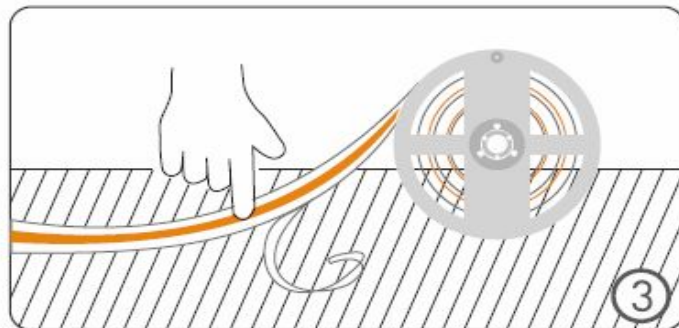
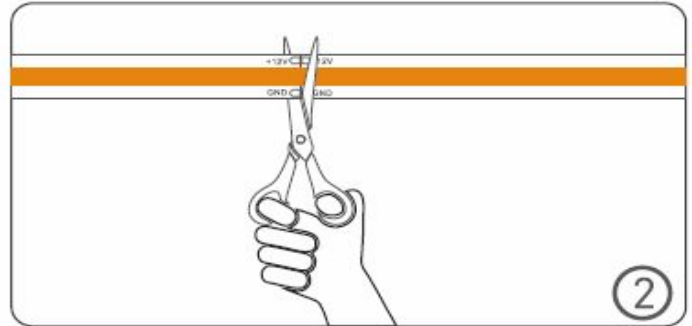
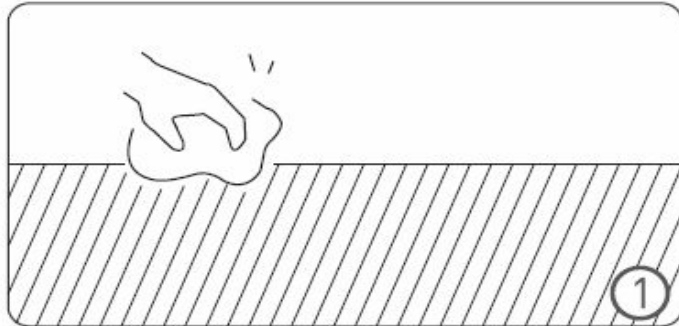

Guidelines

1. The max running length is 10 meters, better with a heat sink to help heat dissipation.
2. Usually, most of the power supply has an efficiency between 80%-95%, so when choosing the power supply, the total watts of the strips should be smaller than 80% of the rated power of the LED Strip Lights.
3. Adjusted the running length by only cutting where the small scissors are located on the strip.
4. Peel the 3M tape off and tape on the area and run the core.
5. Connect the Strip with the power supply



Wiring



Packing Product List

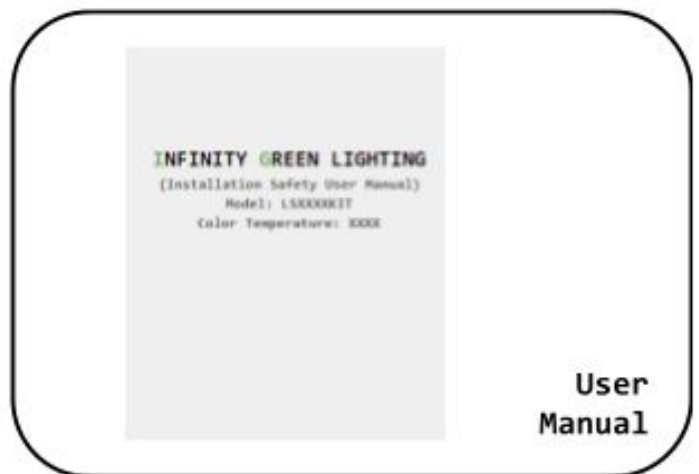

1. Plug-in UL 36W adapter x1
2. Mini Controller with RF 11 Key remote x1
3. 5m (16.4ft) 320 Chip COB LED Strip x1
4. User Manual x 1



Infigreen: LS-24-XXXX-(10M/15M)

LED-Flexible COB Linear Kit

Color Display Based On Model Number

3000K (LS-2430-5M)



5000K (LS-2450-5M)



BLUE (24BL)



GREEN (24GR)

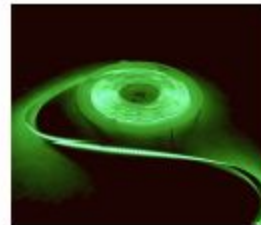

RED (24RED)



YELLOW (24YW)





Making it easy to add additional products is one of the best and easiest ways to boost the value of each design. We have a list of possible accessories you could use for assistance for your installations of COB.

Connection Accessories



**PL-CON
COB Connectors**

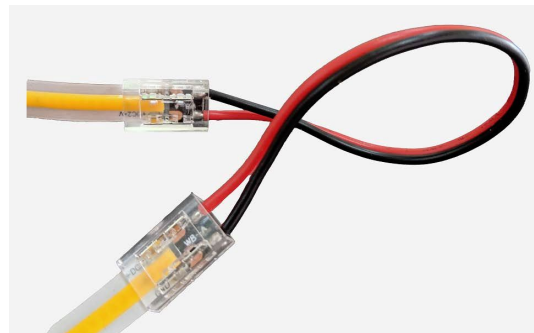

**PL-JCON
COB Jumper Connectors**



**PL-DRC
COB Direct Connectors**



Infigreen: LS-24-XXXX-(10M/15M)

LED-Flexible COB Linear Kit

One of the most common ways to install LED strip light is with an LED channel. In addition to protecting and concealing your LED strip, it provides a polished and professional look for your lighting installation. We offer channels that can be surface mounted, hung, clip mounted, recessed, magnetically adhered and stair mounted. Channel systems consist of two main parts: an aluminum channel and a diffuser or lens. We offer a number of standard designs, as well as some specialized extrusions for specific applications. (More Detail: www.infigreen.com/channel-led/)

Aluminum Channel (Accessories)

	ALP6002 - 8mm Slim Aluminum LED Profile For Surface Mounted		ALP6081R Aluminum profile with PC opal cover
	ALP6013 Aluminum LED Profile For Recessed		ALP6071 Aluminum LED Profile Trimless Recessed
	ALP6014 Aluminum LED Profile For Surface Mounted		ALP6110R Trimless Recessed LED Aluminum Profile Channel
	ALP6083R Aluminum profile with PC opal cover		ALP6110S Aluminum LED profile with 1inch Square Lens

Safety Instructions



LED-Flexible COB Linear Kit

1. Open the package and check if all the components are complete, then unrolling the led strip, and connect the COBstrip to the controller and driver, and light it up to check if all parts are in good condition or not. The connect method should refer to the wiring diagram.
2. Clean the surface on the installation surface, make sure it's clean, dry, and smooth, Or it will reduce the adhesiveness of the back tape. Remember the back tape could be only used one time. The COB strip will fall off if the surface is not in good condition or the back tape is reused.
3. Measure the length required on the surface and cut the COB strip accordingly.
4. Tear off the back tape and paste the strip to the surface smoothly and correctly. Connect the COB strip to the controller and driver based on the diagram.
5. Fix the driver, make sure all the components are tightly and not fall off.

Warning

1. Do not use it outdoors or underwater.
2. Disconnect the power before installation.
3. The operating temperature is -10°C to $+40^{\circ}\text{C}$, please make sure the installation surface should be less than 40°C .
4. Do not use the products close to flammable materials.
5. Do not power the COB strip while it's rolled, or it will overheat and damage.
6. Do not power the COB strip by another power source, like 120VAC or 120VDC, the electronic components will be damaged.
7. Keep the components from children.
8. When installing the Any Led Strip, please use the installation safety instruction. The Led strip can be bent but not distorted, as shown below

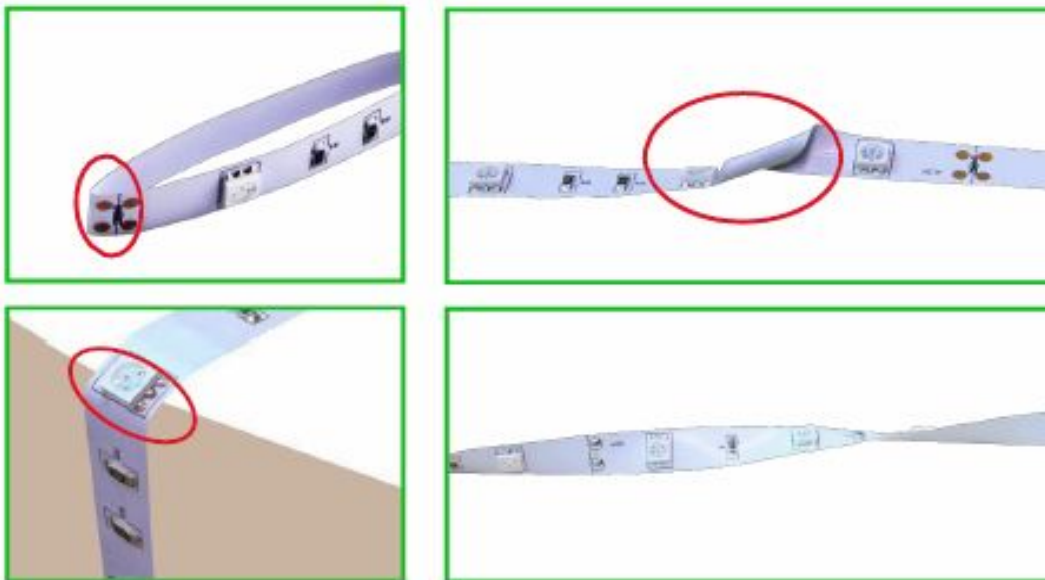



Infigreen: LS-24-XXXX-(10M/15M)

LED-Flexible COB Linear Kit

Customer Service

In order to ensure the product's highest quality and our service. Please contact us at (sales@infigreen.com) for any concerns or questions regarding our product. We will reply within 24-48 Hours during our regular office hours Monday to Friday excluding weekends and holidays.

Thank You For The Interest In Our Product!